

CLAIRFIELDS DRIVE

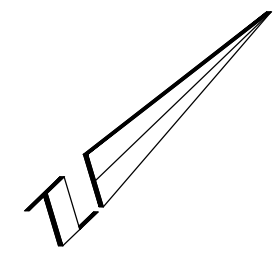

REGISTERED PLAN	61M-39	113	108
132	121	112	109
131	122	111	110
130	123		
129	124		
128	125		
127	126		
126	127		
125	128		
124	129		
123	130		
122	131		
121	132		

MOFFATT LANE

CLAIR ROAD WEST 30.48m WIDE

ROAD ALLOWANCE BETWEEN LOTS 10 & 11

NAME CHANGE BY-LAW (1987)-12029, INSTRUMENT No. 540553

GOSLING GARDENS

ASTRID J. CLOS

PLANNING CONSULTANTS

423 Woolwich Street, Suite 201

Guelph, Ontario N1H 3X3

Email: astrid.clos@ajcplanning.ca

Phone: (519) 836-7526 (836-PLAN)

DRAFT PLAN OF SUBDIVISION 23T-15501

DATE: SEPTEMBER 25, 2018

SCALE 1:1,000

PROJECT No. 1301

DRAWN BY: A.R.N.

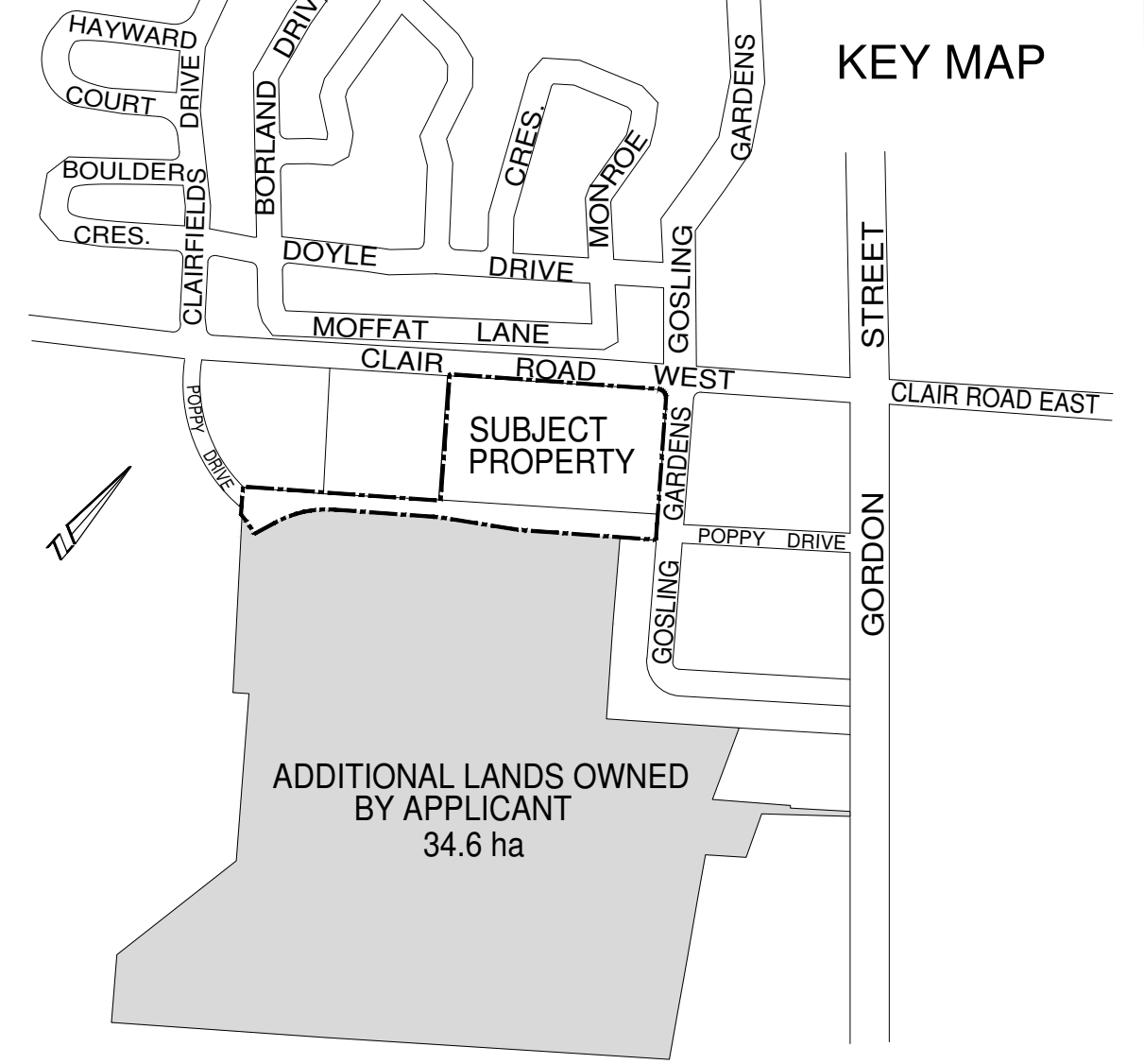

CHURCH SITE

CITY EMERGENCY SERVICES

CORPORATE BUSINESS PARK

BLOCK 1
2.886ha

COMMERCIAL/
RESIDENTIAL
BLOCK 2
0.971ha

COMMERCIAL

SWM
BLOCK 3
0.408ha

FUTURE DEVELOPMENT
BLOCK 4
0.170 ha

POPPY DRIVE

POPPY DRIVE
ESTABLISHED BY 61M-198
20m WIDE

WETLAND

WETLAND

RESIDENTIAL

CONCESSION
LOT 11

WETLAND FLAGGED BY NATURAL
RESOURCE SOLUTIONS ON JULY
28, 2016 AND CONFIRMED BY THE
GRCA ON NOVEMBER 10, 2016.

61R - 952

LOT 11, CONCESSION 7
LOT 12, CONCESSION 7

LEGAL DESCRIPTION

PART OF LOT 11, CONCESSION 7
(GEOGRAPHIC TOWNSHIP OF PUSLINCH)
CITY OF GUELPH

NOTES

- TOPOGRAPHIC INFORMATION PROVIDED BY VAN HARTEN SURVEYING INC.

ADDITIONAL INFORMATION

(UNDER SECTION 51(17) OF THE PLANNING ACT)
INFORMATION REQUIRED BY CLAUSES a,b,c,d,e,f,g,j AND l ARE AS SHOWN ON DRAFT PLAN.

- h) Municipal Water
- i) Silty, sandy gravel with sand and gravel deposits
- j) Soil porosity from 1X10
- k) Municipal Sewer
- l) None

LAND USE SCHEDULE

DESCRIPTION	BLOCKS	AREA (ha.)
CORPORATE BUSINESS PARK	1	2.886
COMMERCIAL/RESIDENTIAL	2	0.971
STORMWATER MANAGEMENT	3	0.408
FUTURE DEVELOPMENT	4	0.170
PARK	5	0.042
ROADS		1.057
TOTAL		5.534

OWNER'S CERTIFICATE

I, JEFF NEUMANN, ON BEHALF OF McENERY INDUSTRIES LIMITED, H & J PRODUCE LIMITED, SIEBEN HOLDINGS LIMITED, FRANK CERNIUK AND HERBERT NEUMANN AUTHORIZE ASTRID J. CLOS, PLANNING CONSULTANTS TO PREPARE AND SUBMIT THIS DRAFT PLAN OF SUBDIVISION.

JEFF NEUMANN

SEPTEMBER 4, 2015
DATE

SURVEYOR'S CERTIFICATE

I CERTIFY THAT THE BOUNDARIES OF THE LAND TO BE SUBDIVIDED AND THEIR RELATIONSHIP TO THE ADJACENT LANDS ARE CORRECTLY SHOWN.

JAMES M. LAWS, O.L.S.
Van Harten Surveying Inc.

SEPTEMBER 4, 2015
DATE